

For Lease

33rd Street Industrial Center #8
4210 LB MCLEOD RD., ORLANDO, FL 32811



BUILDING DATA

Total Building SF: 65,000 SF
Ceiling Height: 22'±
Column Spacing: 28'W x 65'D±
Parking Ratio: Up to .8/1,000 SF
Fire Protection: Wet System
Truck Court: 100'±
Building Depth: 130'±

LISTING DATA

Available SF: 10,920 SF

ECONOMIC DATA

Monthly Rent: \$9,200/month
(Including NNN charges)



Google
©2021 Imagery ©2021 Lake County, Maxar Technologies, U.S. Geological Survey

For Lease

33rd Street Industrial Center #8

4210 LB MCLEOD RD., ORLANDO, FL 32811

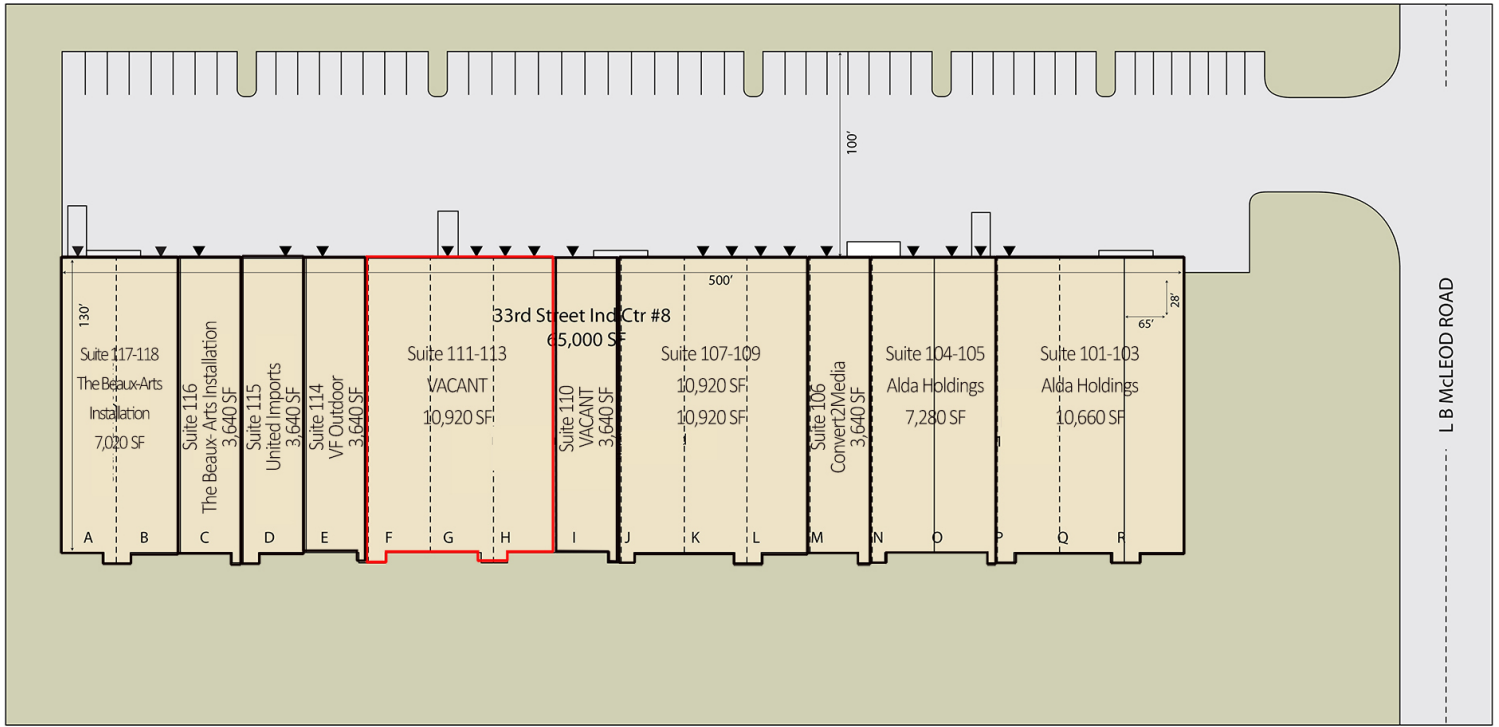

SPACE	SPACE USE	LEASE RATE	LEASE TYPE	SIZE (SF)	OFFICE (SF)	DOORS
Suite 111-113	Warehouse/Distribution	\$9,200 PER MONTH	NNN	10,920 SF	876 SF	3 Dock/1 Ramped

For Lease

33rd Street Industrial Center #8

4210 LB MCLEOD RD., ORLANDO, FL 32811

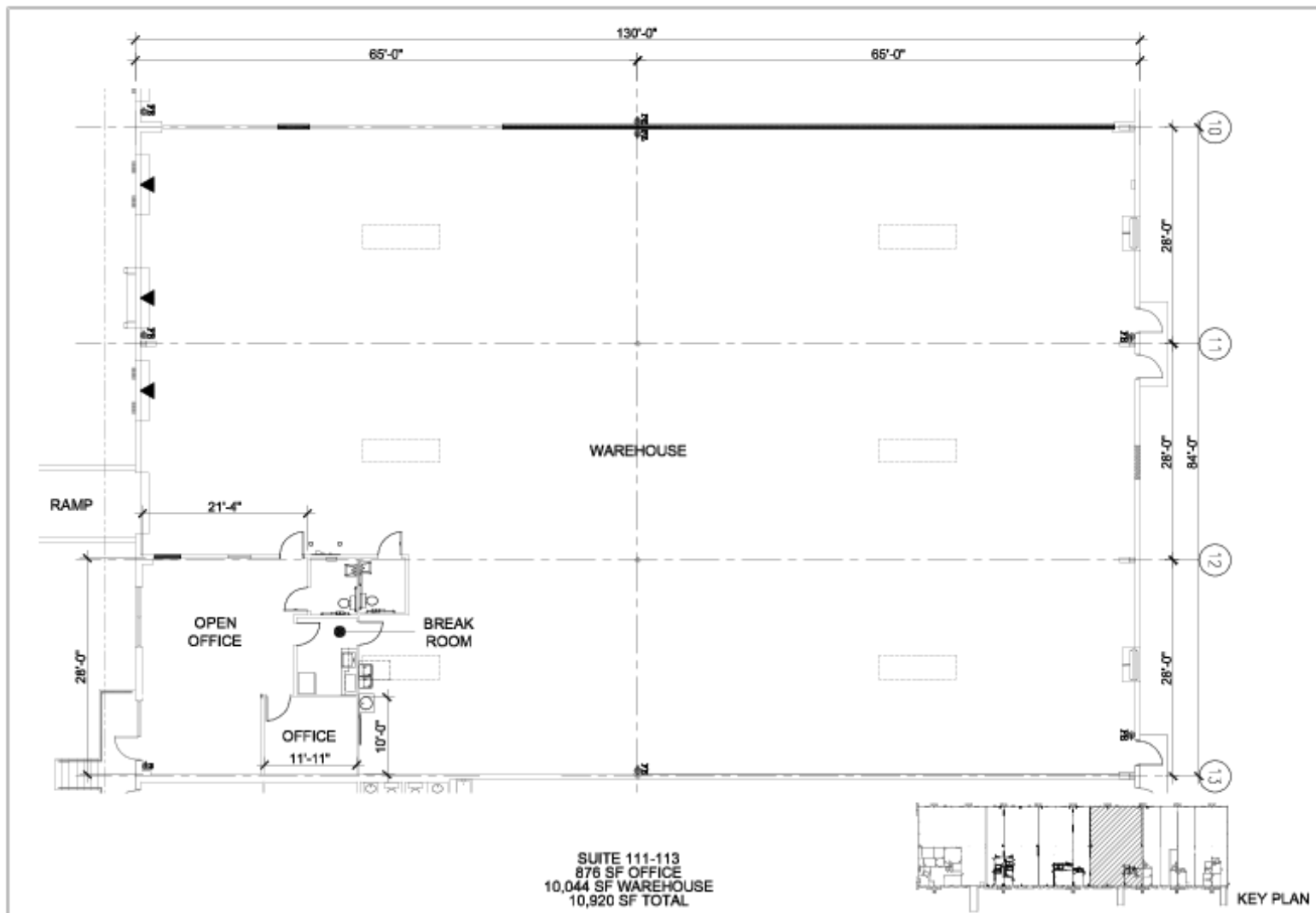

MARCH 20, 2015

4·2·1·0 L·B·M·C·L·E·O·D R·O·A·D
INDUSTRIAL SPACE

ORLANDO, FLORIDA

14201

